

The cutting-edge traffic enforcement systems

FEATURES

- High precision laser-based vehicle speed detection
- Recording traffic regulation violations (with PreTrigger technology)
- Automatic and manual operation
- Portable or Stationary version
- Automatic licence plate recognition (ALPR)
- Day and night mode
- Up to 1600m speed measurement distance
- Up to 160m daytime, 100m nighttime image capturing
- Saved calibrated camera parameters
- Embedded WLAN, GPS, 3G units
- DMC position sensor
- High definition touchscreen
- Up to 4 hours operation time
- True Speed Measurement Filter (TSMF)
- Embedded Solution for Driver Identification (ESDI)
- Vehicle-mounted version for pursuit car (with the seat adapter bracket)
- Target Position Detection (TPD)

BENEFITS

- Ultraportable
- Detection of the measured vehicle's position by TPD
- Sunlight Readable TFT Display
- Operation in moving car
- No moving parts
- Hot swapping battery
- User-friendly graphical user interface
- Easy and quick setup
- One button measuring distance settings
- Police reference

Not all of the features mentioned above are available in every type.

APPLICATION

SPEEDCAPTURE PORTABLE

Portable Installation

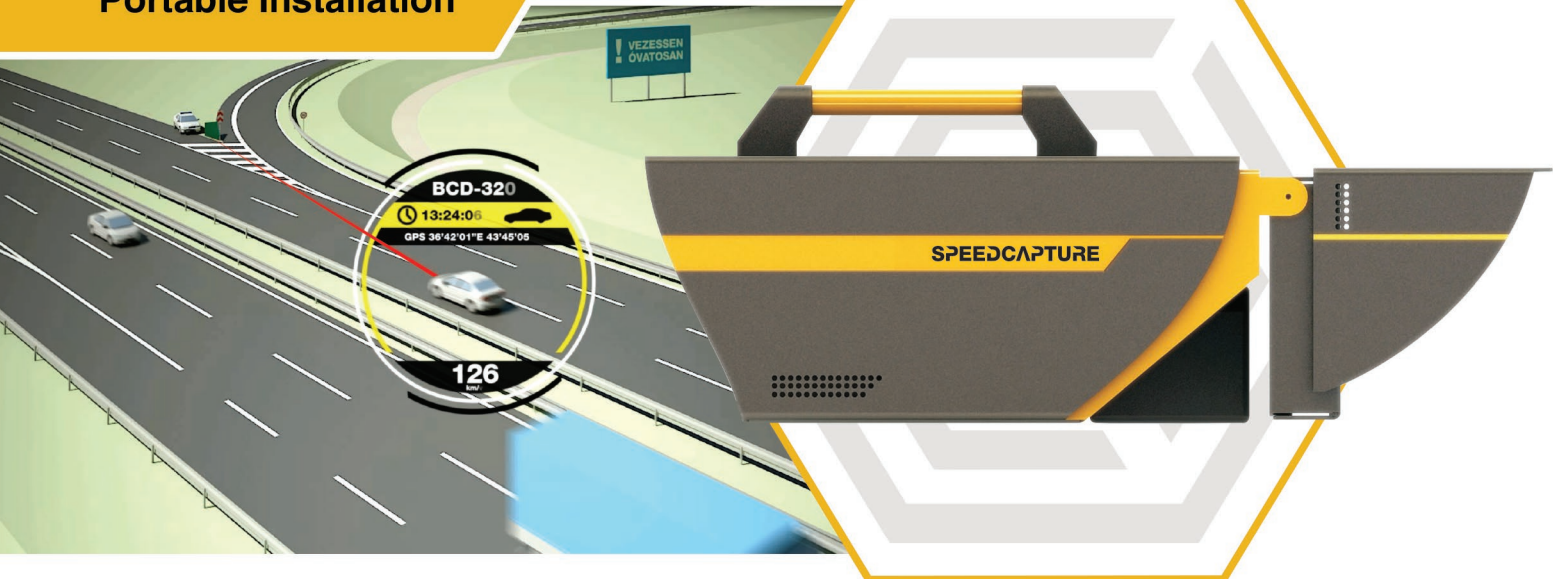

SPEEDCAPTURE MULTISYSTEM

Stationary Installation

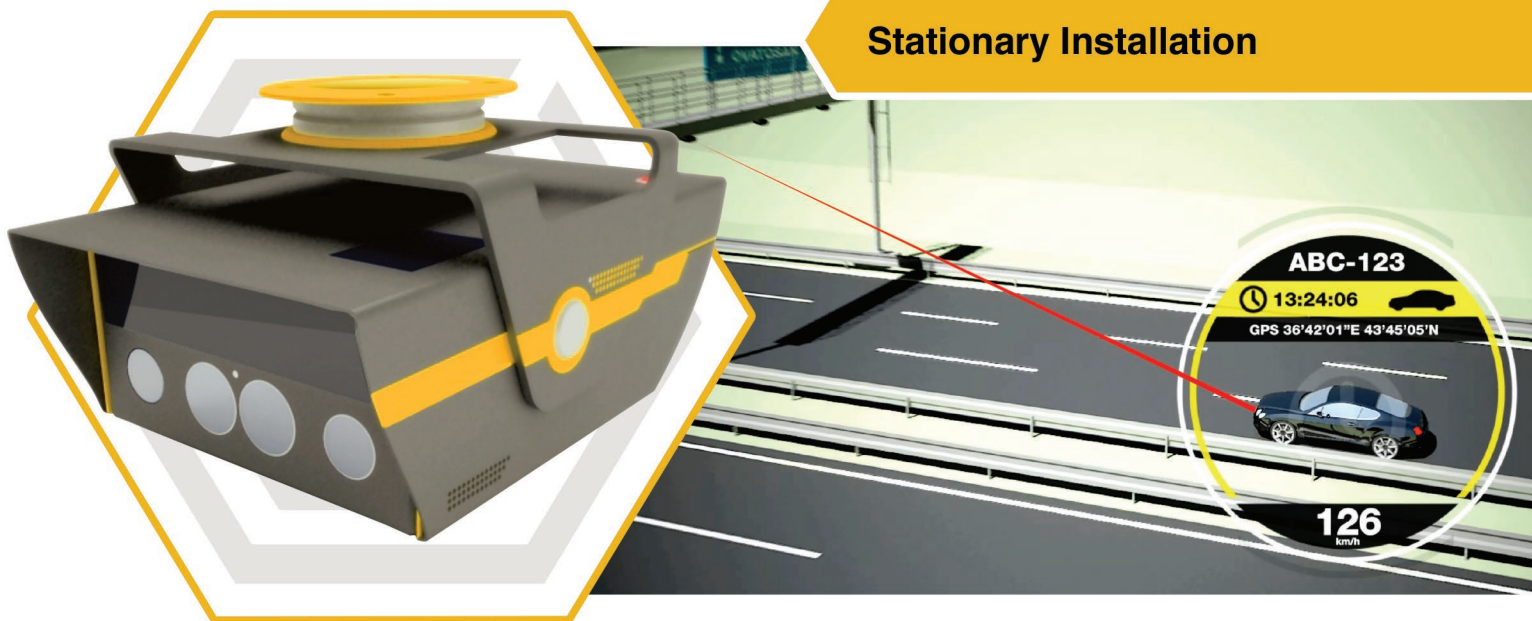

TYPICAL APPLICATIONS

- Speed enforcement
- Section control
- Law enforcement
- Red light enforcement
- Toll collection
- Journey time measurement
- Traffic jam / congestion monitoring
- Bus lane control
- Stolen vehicle detection
- Emergency detection
- Traffic statistics
- Data transfer to/from ITS applications



IMAGING

FRAME RATE	5 frames/s ... 25 frames/s
SENSOR TYPE	1280 X 720 pixels; progressive scan CCD; Y/C
OUTPUT IMAGE FORMAT	JPEG; MJPEG
OVERVIEW SENSOR TYPE	1920 X 1440 pixels; progressive scan CCD; Y/C (only Stationary)
IMAGE PROCESSING	On-board robust embedded system

OPTICS

OPTICAL ZOOM	30x motorized (Portable)
OPTICAL ZOOM	30x motorized; 3,3x motorized (Stationary)
FIELD OF VIEW (HOR)	2.2°...62.9°(Portable)
FIELD OF VIEW (HOR)	2.2°...62.9°; 8.1°...26.3° (Stationary)
IR FILTER	on/off (motorized)
POLARIZING FILTER	motorized (Stationary)
IRIS	auto / manual

ILLUMINATION

LED TYPE	IR 850nm
----------	----------

RANGES

MEASURING OF THE DISTANCE	min.: 15m; max.: 1600m (with cooperative target)
MEASURING SPEED	±320km/h
SOFTWARE FILTER OF TRUE MEASURING SPEED	yes
DISTANCE / SPEED MEASURING ACCURACY	±0,02m / ±2km/h
DISTANCE OF THE IMAGE CAPTURING	160m (daytime); 100m (nighttime)

LASER

WAVELENGTH	905nm
LASER BEAM DIVERGENCE	0.17°
EYE SAFETY CLASSIFICATION	Class 1m (IEC 60825-1:2001)
ACQUISITION TIME OF THE SPEED	0.25s
PULSE FIRING RATE	max.: 5000Hz

COMMUNICATION

TYPES	WLAN, 3G, Ethernet
-------	--------------------

POSITION TECHNOLOGY

TYPES	GPS and optionally MDC (Magnetic Digital Compass)
-------	---

DISPLAY (Portable)

TYPE	SUNLIGHT READABLE TFT LCD DISPLAY (with anti-glare coating)
SIZE	7.0 inch (diagonal)
RESOLUTION	800 x 480 pixels
TOUCH SCREEN INPUT METHOD	Finger or Capacitive Pen
LUMINANCE	> 1000cd/m2

ELECTRICAL PARAMETERS

POWER SUPPLY	9 – 32V DC
CONSUMPTION	max.: 50W (2.6A @ 19V)
REMOVABLE MAIN BATTERY	14.8V; 10.7Ah
BUILT-IN SUBSIDIARY BATTERY	11,1V; 1.2 Ah
OPERATING TIME	4 hours (typical)

MECHANICAL PARAMETERS

DIMENSIONS	350/465mm x 240mm x 140mm
OPERATING TEMPERATURE	-25°C ... +60°C
STORAGE TEMPERATURE	-30°C ... +60°C
IP RATING	IP67 (FIX); IP65 (PORTABLE)
WEIGHT	7kg

ACCESSORIES

TRIPOD (only Portable)
SEAT ADAPTER BRACKET (only Portable)
CARRYING CASE (only Portable)
CIGARETTE LIGHTER ADAPTER (only Portable)
GPS AND 3G EXTERNAL ANTENNA
AC SUPPLY ADAPTER
CABLE SET
SPARE BATTERY (optional)
CLEANING KIT

PHYSICAL CHARACTERISTICS

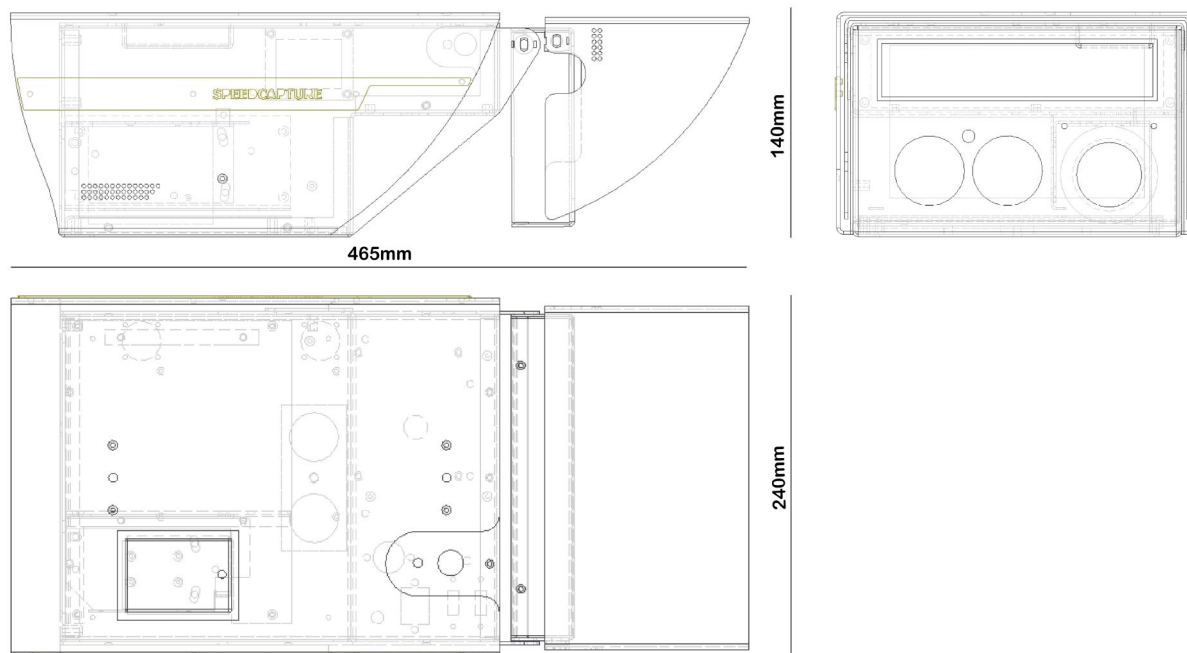

ORDERING INFORMATION

Portable
Portable with MDC
Stationary
Spare battery

SpeedCapture Portable
SpeedCapture Portable MDC
SpeedCapture Multisystem
Li-ion (14.8V, 10.7Ah)

HX-SC106-PTL
HX-SC106-PTL/MDC
HX-SC106-STY
HX-SC106-BAT

(C)opyright 2015 Hexium Co., Ltd.
All text and images in this brochure are protected by copyright law.